

Groenkloof Campus - S 25° 46' 10" E 28° 12' 35"

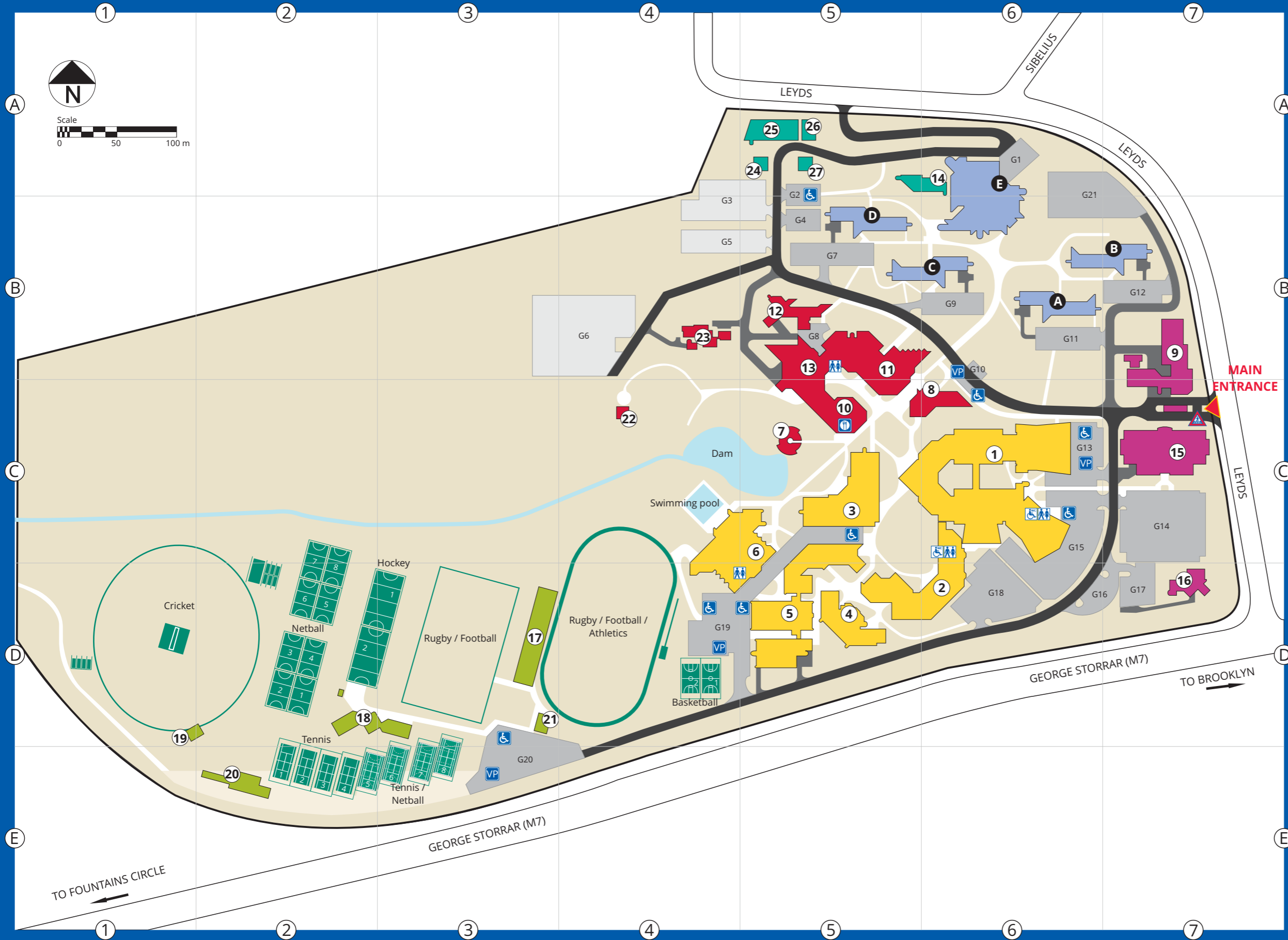

UNIVERSITEIT VAN PRETORIA
UNIVERSITY OF PRETORIA
YUNIBESITHI YA PRETORIA



- 1** UP Buildings
- A** UP Residences / Accommodation
- Other Buildings
- Ring Road
- Walkways
- Roads
- G2 Parking
- VP Visitors' Parking
- ♿ Parking for Disabled Persons
- Student Parking
- Sports Fields
- Vehicle Access
- Pedestrian Entry
- UP Information Desk
- Public Toilets
- Toilets for Disabled Persons
- Retail and Dining Facilities

BUILDINGS			RESIDENCES / ACCOMMODATION		
8 Administration	C6 23 Director: TuksRes	D1 18 Kentucky club house	D2 17 Pavilion	D3 25 Stores	A5 C Ikageng
1 Aldoel Building	C6 3 Faculty Library: Education	B4 26 Kiaat club house	A5 24 Recycling station	E2 9 Technical Services	B7 D Tirisano
11 Auditorium	B5 12 Guest houses 1, 2 and 3	C5 2 Lecture halls	D6 20 Site-contractor complex	C5 5 Technika	D5 A Hayani
7 Boma	C5 16 Guest house 4	B5 15 Letlotlo Building	C7 6 Sports Centre	UP EMERGENCY NUMBER: 012 420 2310	
27 Cleaners' office	A5 22 Jakaranda club house	D7 4 Natural Sciences	D5 21 Sports-fields ablutions		
		C4 13 Normal Hall	B5 14 Staff accommodation	A6	E TuksRes: Dining hall
					B Zinnia

Map updated June 2019
Disclaimer: While every effort has been made to ensure that the information provided on this map is current and accurate, users should not assume that this is always the case. The University of Pretoria makes no representations or warranties of any kind, whether expressed or implied, regarding the accuracy of the map. The University of Pretoria, its employees, officials, suppliers, agents and/or representatives shall not be liable for any loss or damage suffered by the user, whether direct, indirect or consequential, or for any expense of any nature whatsoever resulting directly or indirectly from reliance on the map.