

DEPARTMENT OF ARCHITECTURE UNDERGRADUATE PROGRAMMES 2014/2015

The Department of Architecture, at the University of Pretoria, presents programmes in **architecture, interior architecture and landscape architecture**. These study programmes focus on the design and realisation of space, and as such, complement one another in practice. They employ science and art in the creation of worthwhile environments for users. At the core of the curriculum is a studio-based culture, through which skills in design, theory, communication and management are developed.

The graduates of this Department are highly regarded, both locally and abroad. Through commitment to innovation and internationally accredited programmes in architecture, interior architecture and landscape architecture, the Department promotes a sustainable and prospering South African society.

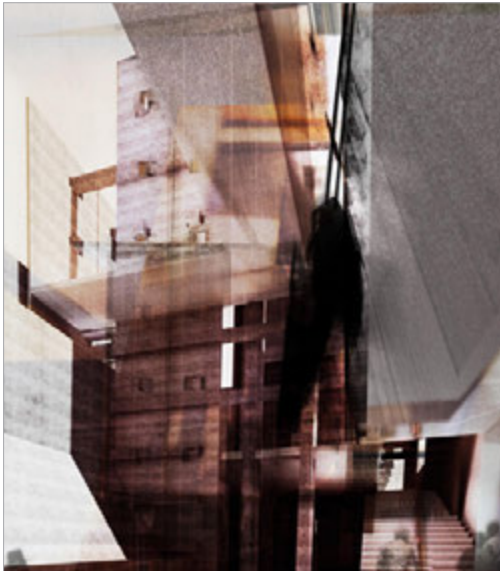

STUDY WITH US



WHAT SKILLS DO I NEED?

All three study programmes require innovators who can satisfy both the need for rational thought and the creative spirit. Designers are curious by nature and are interested in the way people inhabit spaces. You should have good communication skills, as you will work with other built environment professionals such as engineers, surveyors and project managers.

WHAT WILL I LEARN?

Most of your time will be spent in the design studio. Projects completed in the studio are informed by subject modules covering diverse aspects such as construction, environmental design principles, history of the built environment and design communication.

From the second year onwards, students gain programme specific knowledge. Students in the architecture programme focus on the theory of structures, whereas students in the interior and landscape programmes focus on material studies and plant sciences respectively.

HOW DO I APPLY?

See **page 2** of this document for minimum requirements and **pages 3 and 4** for general information. Admission is by selection and you must apply timeously.

APPLICATIONS CLOSE: 30 JUNE 2014

CONTACT US

www.up.ac.za/architecture
arch@up.ac.za

1



UNIVERSITEIT VAN PRETORIA
UNIVERSITY OF PRETORIA
YUNIBESITHI YA PRETORIA
Denkeleers • Leading Minds • Dikgopolo tša Dihlalefi

DEPARTMENT OF ARCHITECTURE
UNDERGRADUATE PROGRAMMES

2014/2015

LANDSCAPE ARCHITECTURE

Validated by the South African Council for the Landscape Architectural Profession (SACLAP)

Landscapes are the represented expressions of the dynamic interaction between the technological and cultural activities of human societies with the physical environment. Landscape architecture is a profession and academic discipline concerned with the design of rural and urban outside places on various scales informed by this interaction. It considers change over time and mediates art and science; artefact and nature; city and region; and private and public interests. Landscape architects therefore synthesise knowledge from the humanities and the sciences to sustainably design meaningful and beautiful places that are grounded in material and immaterial culture, and ecology of their local contexts.

The programme in landscape architecture is the only undergraduate course of its kind offered in South Africa. Locally there is a great demand for practitioners in both the public and private sector.

UNDERGRADUATE (By course work)	MINIMUM DURATION	OUTCOME (Registration with SACLAP)
BSc(LArch)	3 years (full-time, studio based)	Candidate Landscape Architectural Technologist
<i>Recommended period of work or travel</i>	<i>at least one year</i>	
POSTGRADUATE (By course work)		
BL(Hons)	1 year (full-time, studio based)	Candidate Landscape Architectural Technologist
ML(Prof)	1 year (full-time, studio based)	Candidate Landscape Architect

NOTE: The Department also offers postgraduate degrees by research and postgraduate degrees in applied science. For more information please visit www.up.ac.za/architecture

The courses listed above are **selection programmes** (selection includes an interview) - details on page 3 of this document.

The minimum requirements* for the **BSc(LArch) - Baccalaureus Scientiae in Landscape Architecture** are as follows:

AFRIKAANS or ENGLISH: 5 (60 - 69%)	MATHEMATICS: 4 (50 - 59%)	PHYSICAL SCIENCE / GEOGRAPHY / LIFE SCIENCES: 4 (50 - 59%)	APS: 27
---	----------------------------------	---	----------------

* Meeting the minimum requirements does not guarantee admission as the programmes by course work are offered to a limited number of students.

INTERIOR ARCHITECTURE

Recognised by the South African Institute for the Interior Design Professions (IID)

The Programme in Interior Architecture empowers students to design sustainable, meaningful and beautiful places within the context of architectural space. Graduates possess the theoretical and technical knowledge to engage critically with proposed or existing structures. Designers of interior environments shape the relationship between space, object and user. They follow a human-centred approach and perform spatial design and research services across various scales and typologies. Graduates work as designers in the built environment and related fields such as exhibition, lighting, product and stage design. The programme offers students the opportunity to become specialists in interior design within an interdisciplinary learning environment.

The programme in interior architecture is one of only four similar programmes in South Africa with educational membership at the International Federation of Interior Architects / Designers (IFI).

UNDERGRADUATE (By course work)	MINIMUM DURATION	OUTCOME (Registration with IID)
BSc(Int)	3 years (full-time, studio based)	Candidate Interior Designer
<i>Recommended period of work or travel</i>	<i>at least one year</i>	
POSTGRADUATE (By course work)		
Blnt(Hons)	1 year (full-time, studio based)	Candidate Senior Interior Designer
MInt(Prof)	1 year (full-time, studio based)	Candidate Interior Architect

NOTE: The Department also offers postgraduate degrees by research and postgraduate degrees in applied science. For more information please visit www.up.ac.za/architecture

The courses listed above are **selection programmes** (selection includes an interview) - details on page 3 of this document.

The minimum requirements* for the **BSc(Int) - Baccalaureus Scientiae in Interior Architecture** are as follows:

AFRIKAANS or ENGLISH: 5 (60 - 69%)	MATHEMATICS: 4 (50 - 59%)	PHYSICAL SCIENCE: 4 (50 - 59%)	APS: 27
---	----------------------------------	---------------------------------------	----------------

* Meeting the minimum requirements does not guarantee admission as the programmes by course work are offered to a limited number of students.

ARCHITECTURE

Validated by the South African Council for the Architectural Profession (SACAP) and recognised by the Commonwealth Association of Architects (CAA)

Architects design spaces and buildings to satisfy daily needs and improve the environment in which we live. They need abilities and skills that range from the practical to the artistic and from the technical to the theoretical. As professionals they conceptualise, design and document building projects and oversee quality control during construction. Architects are ethically and legally bound through Institutes and government controlled Councils which protect the interests of the public. Architects can manage their own practices or work for other, often, multidisciplinary firms, or can make contributions to the government sector and education.

UNDERGRADUATE (By course work)	MINIMUM DURATION	OUTCOME (Registration with SACAP)
BSc(Arch)	3 years (full-time, studio based)	Candidate Architectural Technologist
<i>Recommended period of work or travel</i>	<i>at least one year</i>	
POSTGRADUATE (By course work)		
BArch(Hons)	1 year (full-time, studio based)	Candidate Senior Architectural Technologist
MArch(Prof)	1 year (full-time, studio based)	Candidate Architect

NOTE: The Department also offers postgraduate degrees by research and postgraduate degrees in applied science. For more information please visit www.up.ac.za/architecture

The courses listed above are **selection programmes** (selection includes an interview) - details on page 3 of this document.

The minimum requirements* for the **BSc(Arch) - Baccalaureus Scientiae in Architecture** are as follows:

AFRIKAANS or ENGLISH: 5 (60 - 69%)	MATHEMATICS: 4 (50 - 59%)	PHYSICAL SCIENCE: 4 (50 - 59%)	APS: 27
---	----------------------------------	---------------------------------------	----------------

* Meeting the minimum requirements does not guarantee admission as the programmes by course work are offered to a limited number of students.

CLOSING DATES:	UNDERGRADUATE 30 JUNE 2014	POSTGRADUATE 30 SEPTEMBER 2014	NOTE: International postgraduate applications close on 31 August 2014
-----------------------	--------------------------------------	--	---



GENERAL INFORMATION

for all undergraduate degrees

1. APPLICATIONS

Prospective students can apply by submitting a completed application form before the cut-off date. Forms can be obtained from, and are submitted directly to, the Client Service Centre ('12. Contact Details', p.4). For online applications, visit the website of the University at www.up.ac.za and follow the 'New Students' link.

Please ensure that all required supporting documents, such as certified copies of identity documents (IDs) and school results, are submitted before the closing date for applications. Incomplete applications cannot be considered for selection. Applicants who have not completed their Grade 12 studies yet must state their final Grade 11 results in their application. These results will serve as the basis on which they will be considered during the first round of selection.

A limited number of students are admitted to the Department. In view of the large number of applications received annually, prospective students who indicate programmes offered by the Department as their second choice are not considered for selection. All applicants are advised to consider other alternatives in the event of their applications being unsuccessful.

2. MINIMUM REQUIREMENTS FOR ADMISSION

The following minimum requirements for admission apply:

- A National Senior Certificate with **university admission**;
- **English or Afrikaans** at Home or First Additional Language Level: min. achievement rating of 5 (at least 60%);
- **Mathematics**: min. achievement rating of 4 (at least 50%);
- **Physical Science¹**: min. achievement rating of 4 (at least 50%);
- **Life Orientation**: min. achievement rating of 4 (at least 50%), although this subject is not used in the calculation of the APS;
- **Admissions Point Score (APS)** of 27, calculated according to the following formula:

$$\begin{array}{r} \text{University's language of instruction: English or Afrikaans} \\ + \\ \text{Other language} \\ + \\ \text{Mathematics} \\ + \\ \text{Physical Science}^1 \\ + \\ \text{two other subjects (excluding Life Orientation)} \end{array}$$

EXAMPLE OF APS CALCULATION:

PRESCRIBED SUBJECTS	MARK	RATING CODE
Subject Group A		
Home Language	82	7
Language at First Additional Level	65	5
Mathematics	58	4
Life Orientation	72	-
Subject Group B		
Physical Science ¹	63	5
OTHER SUBJECTS		
for example Life Sciences	76	6
for example Accounting	55	4
TOTAL APS:		31

Only six values are used in this formula, which means that the maximum possible APS is 42 for six subjects passed with an Outstanding Achievement rating (above 80%).

NOTES

1 As of 2011:

For the BSc(Landscape Architecture) programme Physical Science or Life Sciences or Geography will be accepted at a minimum of 50%.

3. SELECTION PROCESS

Meeting the minimum requirements does not guarantee admission. Admission is granted on the basis of selection, which involves two rounds:

In **ROUND ONE**, candidates are assessed on academic merit. Those who meet the minimum requirements for admission are invited to participate in the second round by taking the departmental selection test. With the invitation, they also receive assignments to complete at home and submit on the day of the test.

In **ROUND TWO**, candidates are assessed on their general knowledge and interests, a broad spectrum, of abilities, their motivation and experience by means of a departmental selection test. A final shortlist is compiled based on the outcome of both the tests and home assignments. Those candidates whose names are on the shortlist are invited to selection interviews, following which the final selection and waiting list placements are made.

While candidates should preferably attend their test and interview, applicants unable to do so may request further selection material to be sent by mail. A telephonic interview may then be granted. For further information regarding the selection process, visit www.up.ac.za/architecture and follow the '**Selection**' link.

Matriculants are provisionally selected - in order to retain selection, they must still meet the minimum requirements for admission in their final Grade 12 examinations (also see '10 National Benchmark Test (NBT)', p4). The decision of the Selection Committee is final and no discussion or correspondence will be entered into.

4. PORTFOLIOS

Traditional portfolios (with art or technical drawings) are not required for selection. To be more clear, applicants receive assignments (minor research projects and some simple freehand drawings) to prepare at home in their own time; this is followed up by similar tasks during a selection test, where resources are not available and time is limited. Apart from academic merit, our selection is based on a holistic evaluation of the candidate's general knowledge and interests, skills, experience and motivation.

5. SIGNIFICANT DATES

The University of Pretoria's academic year starts in February and ends early in December. It is divided into two semesters, with short recesses in April, July and September. Students are advised to gain practical work experience during the university recesses. The University calendar is available online at www.up.ac.za/calendars

1 MARCH

Applications for admission open for the next academic year.

30 JUNE

Last day for all undergraduate applications (including transfer applications) for admission to the Department of Architecture for the following academic year. Late and incomplete applications cannot be considered.

PRACTITIONERS DAY: 2 AUGUST 2014

Practitioners from all three disciplines visit the Department of Architecture. Applicants may be invited to attend and learn more about their professions.

SELECTION TESTS

FRIDAY: 22 AUGUST 2014 (14:00-18:30), 5 SEPTEMBER 2014 (14:00-18:30)
SATURDAY: 30 AUGUST 2014 (08:30-13:00), 30 AUGUST 2014 (14:00-18:30)
Dates are automatically allocated and cannot be rescheduled.

OCTOBER RECESS: 4 OCTOBER – 12 OCTOBER 2014

Final selection interviews for applicants on the shortlist.

31 OCTOBER

Final selection results available. Applicants are notified of the outcome by SMS and in writing.

30 NOVEMBER

Last day for selected students to acknowledge their selection and pay deposits or make arrangements for payment. Thereafter candidates on the waiting list are placed should there be cancellations.



6. OPEN DAY: SATURDAY 24 MAY 2014

The University of Pretoria hosts an annual open day on the Hatfield campus. Student work is on display and lecturers and advisors are available to answer questions. Prospective students are strongly advised to attend. Two information sessions are presented at **09:00** and again at **11:00** in the Building Science building (*Boukunde*) in Auditorium 3-3.

7. APPLICANTS WHO MATRICULATED BEFORE OR IN 2007

The following minimum requirements for admission apply: a Grade 12 Certificate with university endorsement and at least 40% (E symbol) in Mathematics and Physical Science¹ on Higher Grade, or at least 50% (D symbol) for the same subjects on Standard Grade. A minimum M score of 18 is required for Grade 12. For instructions on calculating the M score, please contact the Department: arch@up.ac.za

8. INTERNATIONAL STUDENTS

Admission requirements for international matriculants differ from those for applicants writing the South African Grade 12 examination. Non-South African residents should note that a study permit is required. It is the candidate's responsibility to make the necessary arrangements in this regard. An exemption certificate is required for admission and must be obtained from the Matriculation Board, Higher Education South Africa (HESA):

SOUTH AFRICAN MATRICULATION BOARD

Matriculation Board & Exemption Certificates:

Tel: 0010 591 4401/2 local / +27 010 591 4401/2 international
Online: www.hesa.org.za

International students are advised to apply timeously and to submit both their exemption certificates and certified copies of final-year school certificates. All certificates issued in a foreign language must be translated into English by an accredited translator. Note that incomplete applications cannot be considered for selection.

Please contact the Client Service Centre (see '12. Contact Details') for information on study permits, medical insurance, tuition fees and levies.

9. TRANSFERRING STUDENTS

Students currently enrolled for other study programmes may apply for permission to transfer to the Department of Architecture. For these applicants, round one of the selection process will be based on:

- Grade 12 results (refer to '2. Minimum Requirements For Admission', p3);
- Current academic record;
- Detailed written motivation, explaining reasons for wanting to transfer.

Students currently registered at UP can submit their application directly to the Admissions Officer, Faculty of Engineering, Built Environment and Information Technology (see '12. Contact Details') and need not apply through the Client Service Centre. Students registered at other tertiary institutions must apply through the Client Service Centre. Applicants will not be permitted to register for any modules in advance (i.e. prior to having been granted final admission). Please note that applications close on 30 June annually.

10. NATIONAL BENCHMARK TEST (NBT)

Although the Department of Architecture **does not require** of applicants to write the National Benchmark Test (NBT), applicants are **advised** to do so. In cases where selected students fail to maintain their Grade 11 results in Grade 12, and as a result no longer meet the minimum admission requirements, the NBT results may be considered.

In special cases the Admissions Officer will inform candidates of the arrangements should the test be an additional requirement. Candidates who also apply at other departments or institutions are advised to enquire if these tests are required elsewhere.

Please refer to the NBT website for more information: www.nbt.ac.za

11. LANGUAGE POLICY

Lectures are presented in both Afrikaans and English where economically viable and practical, but only in English in certain specialist areas where the lecturer is not conversant in Afrikaans.

12. CONTACT DETAILS

The Department of Architecture does not deal with the administrative aspects of student affairs, such as applications, tuition fees or bursaries. Prospective students should address queries in this regard, as well as their applications for admission, to the Client Service Centre.

APPLICATIONS AND GENERAL ENQUIRIES

Client Service Centre, University of Pretoria

Lynnwood Road entrance, Main Campus, University of Pretoria

Tel: 012 420 3111 local / +27 12 420 3111 international

Fax: 012 420 4555 local / +27 12 420 4555 international

Email: csc@up.ac.za

ACADEMIC ENQUIRIES: PROSPECTIVE STUDENTS

Elana van der Wath, Department of Architecture

Building Science building (*Boukunde*), UP Main Campus

Tel: 012 420 2182 local / +27 12 420 2182 international

Fax: 012 420 2552 local / +27 12 420 2552 international

Email: arch@up.ac.za

ENQUIRIES ABOUT APPLICATIONS AND SELECTION

Jenny van Rooyen, Admissions Officer, Faculty of Engineering,

Built Environment and Information Technology

Room 6-9, Engineering Building 1, UP Main Campus

Tel: 012 420 5166 local / +27 12 420 5166 international

Fax: 012 420 4669 local / +27 12 420 4669 international

Email: jvr2@up.ac.za

13. USEFUL CONTACTS

University of Pretoria: www.up.ac.za

For a description of regulations, subject modules and syllabi, visit the page below and select '[Built Environment](#)':

www.up.ac.za/yearbooks

LANDSCAPE ARCHITECTURE:

For an overview of important projects, achievements and events that take place in the Programme in Landscape Architecture, download **BOUKUNDELANDSCAPE news**. Visit the page below and select '[News letters](#)':

www.up.ac.za/architecture

For general information on the discipline, visit the following websites:

- The South African Council for the Landscape Architectural

Profession (SACLAP):

www.saclap.org.za

- Institute of Landscape Architects of South Africa (ILASA):

www.ilasa.co.za

INTERIOR ARCHITECTURE:

For an overview of important projects, achievements and events that take place in the Programme in Interior Architecture, download **BOUKUNDEINTERIOR news**. Visit the page below and select '[News letters](#)':

www.up.ac.za/architecture

For general information on the discipline, visit the following websites:

- The South African Institute of the Interior Design Professions (IID):

www.iidprofessions.org.za

- International Federation of Interior Architects/Designers (IFI):

www.ifiworld.org

ARCHITECTURE:

For general information on the discipline, visit the following websites:

- The South African Council for the Architectural Profession (SACAP):

www.sacapsa.com

- The South African Institute of Architects (SAIA):

www.saia.org.za